

1 2 3 4 5 6 7 8 9 10 11 12 13

DRAWN TO BS 308

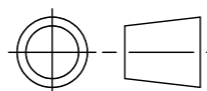

3RD ANGLE PROJECTION

REMOVE ALL BURRS & SHARP EDGES

Power Specification

Single Phase 200/240 Vac 50/60Hz
 Max Current 40A
 Cable Size 6mm²

Specification

Fan Speed fully controllable via software
 Machine weight 350Kg
 Controlled by Dyna Run Software
 Volume 6000/9000m³Hr
 Max Static Pressure 1.2kPa
 Max Sound Level 80dB

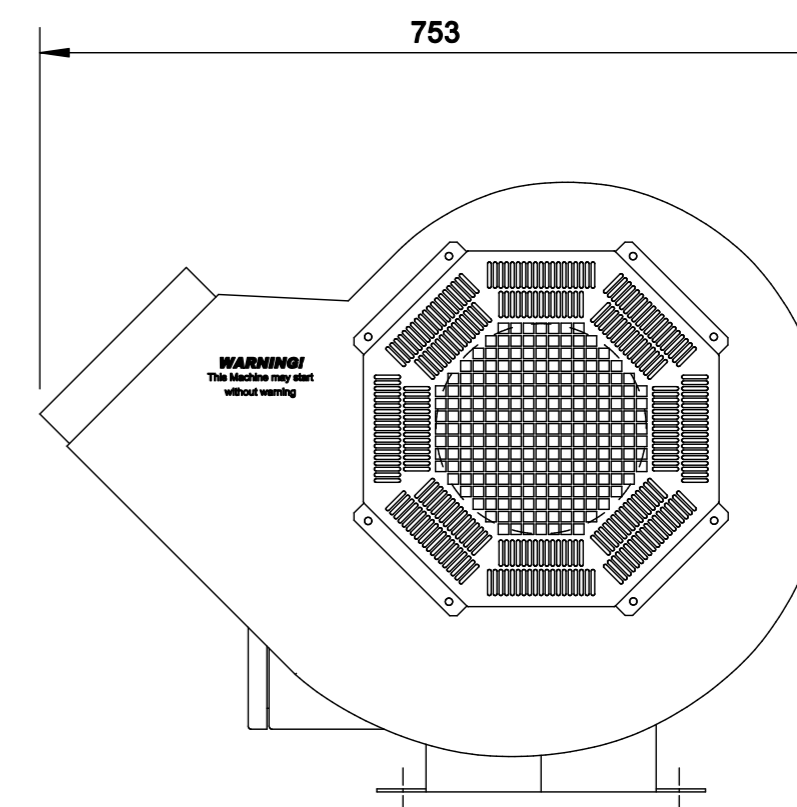
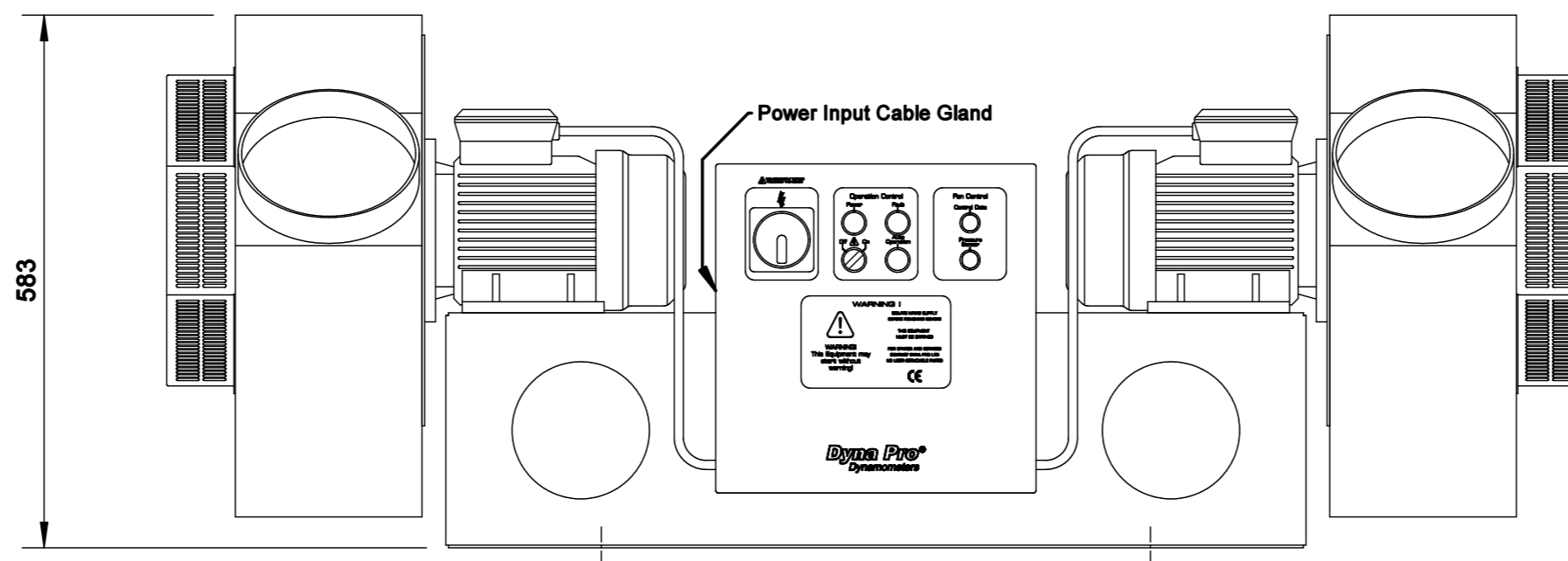
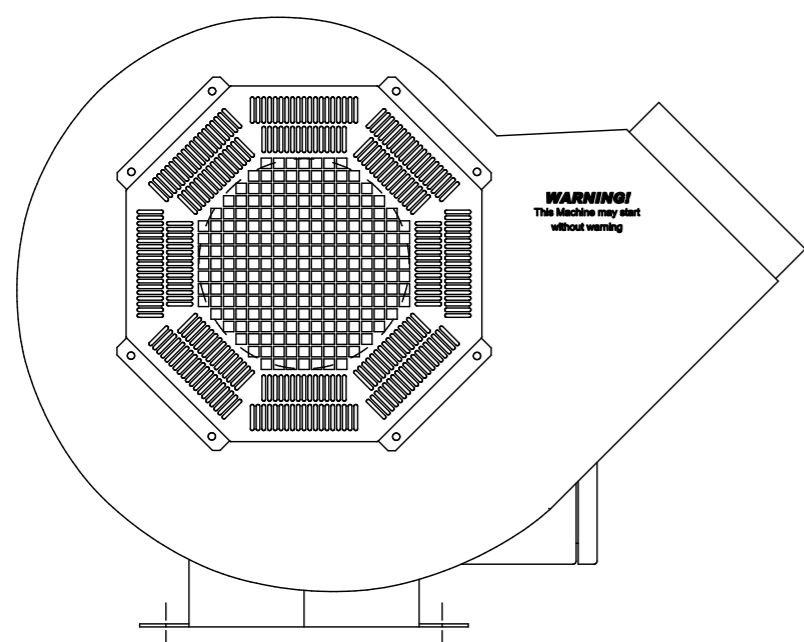
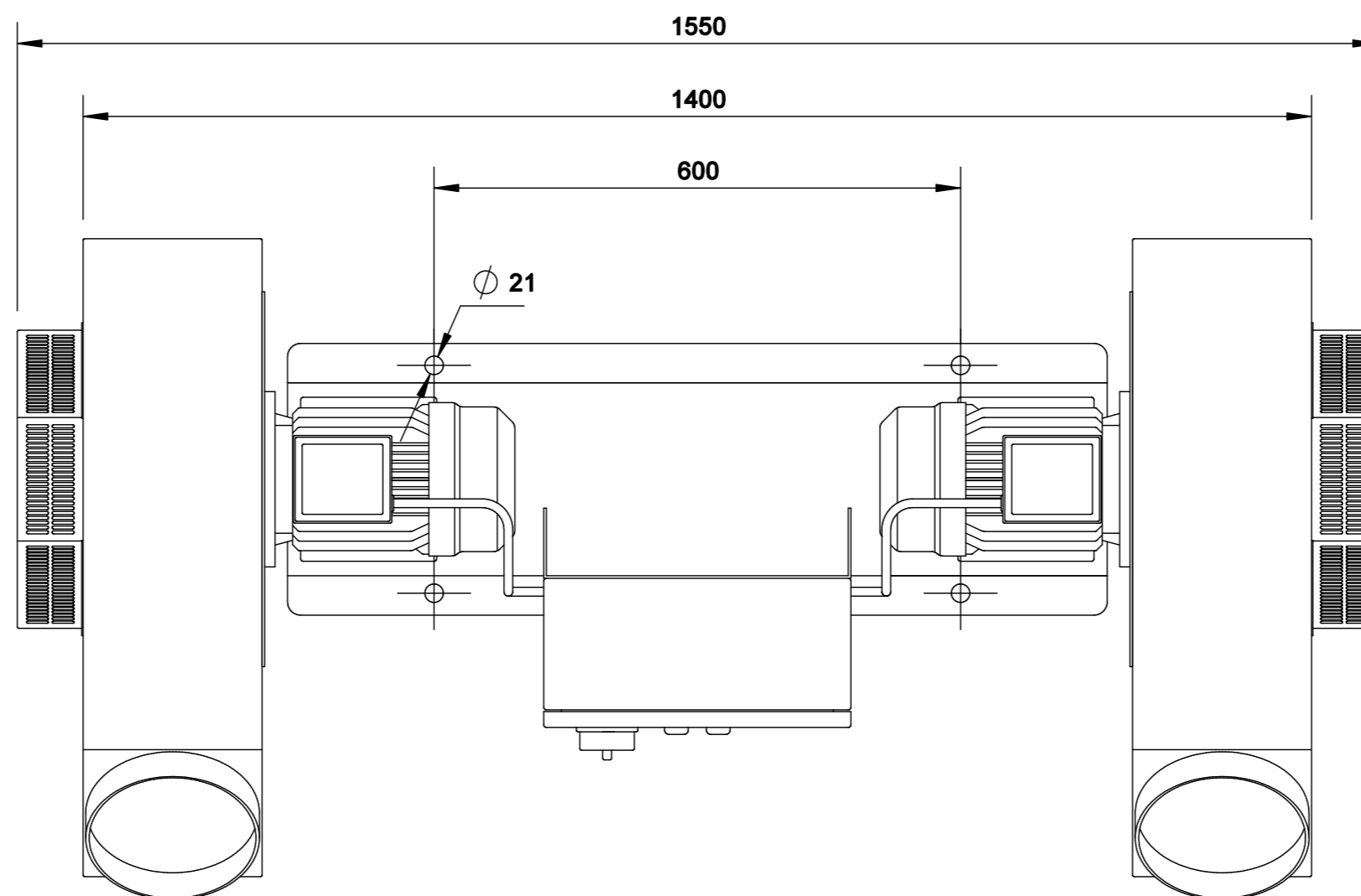

A

Specifications subject to change without notice.

Dyna Pro
 Dynamometers

Unit 18 Sherrington Way
 Lister Road Industrial Estate
 Basingstoke Hampshire
 United Kingdom RG24 4DQ
 Copyright © Dyna Pro Dynamometers Ltd 2011

Tel +44 (0) 8000 4321 68
 www.dynapro.co.uk

| ISSUE | CHANGE / CHANGE NOTE No. | DATE | DRAWN | DATE | CHECKED |
|----------------------------|--------------------------|----------|---------------|----------|-----------|
| A | FIRST PRODUCTION | 19/10/09 | K.W DENT | 19/10/09 | |
| TITLE | | | SHEET 1 OF 1 | | SCALE 1:1 |
| Power Fan System (RAM-Air) | | | DRAWING No. | | ISSUE |
| | | | DP-PF-1000-1A | | A |

1 2 3 4 5 6 7 8 9 10 11 12 13